



coolenergy

TEMPERATURE RENTAL

Cooling Tower

2,000kW Rental Unit



ABOUT THE COOLING TOWER

Cool Energy's 2,000kW cooling tower is a flexible twin fan unit capable of managing 310,000m³/hr flow. The unit requires a water source to top up the evaporation and has quick-release water connections, together with a 63amp 3-phase power connection.

The unit is designed specifically by Cooling Tower specialists - Evapco, for the UK market and for the adherence of ACOP L8 site maintenance requirements.

No Cooling Tower will be delivered to site until a full site specific risk assessment is agreed, together with a declaration of known tasks prior to delivery.

GA DRAWING

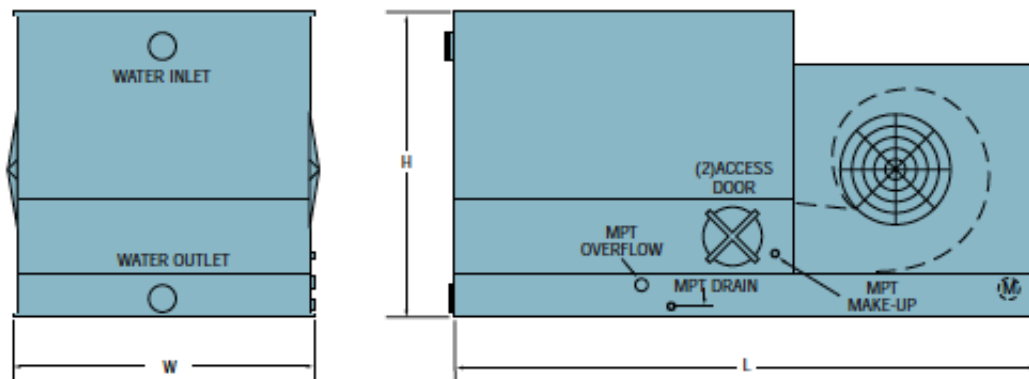

TECHNICAL

2,000kW Cooling Tower

Performance data @ design conditions

| | | |
|----------------------|------|--------------|
| Cooling Capacity | kW | 2,000 |
| Design Wet Bulb Temp | °C | 20 |
| Design Fluid In/Out | °C | 35/30 |
| Method of Cooling | Type | Forced Draft |

Cooling Operating limits

| | | |
|-------------------------------|-----------|-------------|
| Min/Max Duty | kW | 1,000/2,100 |
| Min/Max Water Off Temperature | °C | 10/35 |
| Fluid Pressure Drop | kPa | 23.4 |
| Min/Max Flowrate | L/S | 30/86.1 |
| Water Volume | L | 2,500 |
| Water Connection | mm/inches | 50/2 |
| Evaporated Water Rate | L/S | 0.62 (Max) |

Air Limits

| | | |
|-------------------|--------------------|--------|
| Total Number Fans | No. | 2 |
| Total Airflow | m ³ /hr | 99,720 |
| | m ³ /s | 27.7 |

Electrical data

| | | |
|---|-----|----------------------------|
| Electrical Supply Voltage 3 phase | V | 400 |
| Power Connections (without heaters) | A | 63 C forme plug |
| Cable Connections (35mm ² per phase) | | 3 core + earth, no neutral |
| Max Power Absorbed | kW | 22 |
| Max Current Absorbed | A | 43 |
| Starting Current (Max) | A | 100 (soft start) |
| Recommended Generator Set | kVA | 40 |
| Defrost Heater | No. | 1x 9kW |

Sound Data

| | | |
|--|-------|----------------|
| Sound Pressure Level at 15 metres (ISO3744) Max Air Flow | dB(A) | 63 (@ 1.5m 75) |
|--|-------|----------------|

Physical Data

| | | |
|----------------------------------|---------|-------------------|
| Overall Length | mm | 5,553 |
| Overall Width | mm | 2,388 |
| Overall Height | mm | 2,426 |
| Weight Dry | kg | 2,318 |
| Weight + Water/Glycol mix | kg | 4,971 |
| Fluid Coupling Size | mm/inch | 200/8 |
| Fluid Coupling Type | Std | PN16 flange/bauer |
| Dosing Connections | mm/inch | 50/2 |
| Make-up water pressure (Min/Max) | mm/inch | 137/344 |

ADDITIONAL INFORMATION

The Cool Energy water cooled rental range can be supplied with a suitably-rated rental cooling tower as an option, to help provide temporary cooling as a complete package.

The range available for rental is 45kW - 1,290kW single units.

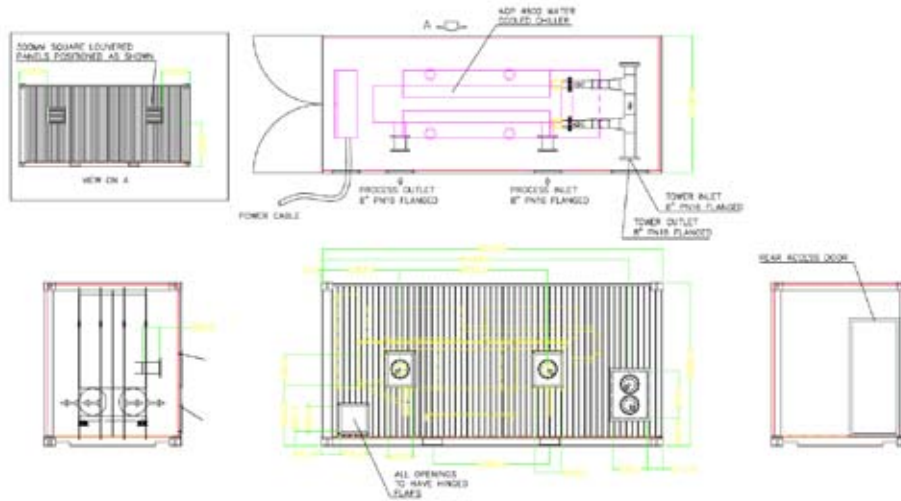

Aquarius Plus 4802

Head Office South

ICS House, Stephenson Road, Calmore Industrial Estate, Totton, SO40 3RY
T (+44) 23 8052 7300 F (+44) 23 8042 8366

Midlands

Unit 82 Plume Industrial Estate, Holburn Hill, Aston, Birmingham B6 7RT
T (+44) 121 326 7771 F (+44) 121 327 4114

North

Floor 2, Caspian House, East Parade, Little Germany, Bradford BD1 5EP
T (+44) 1274 740 877 F (+44) 1274 391 708

Scotland

Unit 5, 53/58 South Avenue, Blantyre Industrial Estate, Blantyre, G72 0XB
T (+44) 1698 723308 F (+44) 1698 723309

Ireland

Unit 2, Kells Enterprise Centre, Cavan Road, Kells, County Meath, Ireland
T (+353) 46 925 2934 F (+353) 46 925 2936

We also have four locations in Germany in Munich, Guglingen, Hagen and Leipzig. Further information on these locations can be found at www.coolenergy.de



coolenergy

TEMPERATURE RENTAL

www.coolenergy.co.uk

Equipment designed to ISO-9001 and all relevant directives. Product improvement is a continual process at Cool Energy and we reserve the right to change the design and specifications without notice or obligation. Availability is subject to change without notice. Contact your local Cool Energy depot for availability. © 2010 Cool Energy. All rights reserved.